

Lampada LED PL-C 4 PIN 2G11 TERMOPLASTICA

14W

96W

1450lm



Tipo di Attacco

2G11

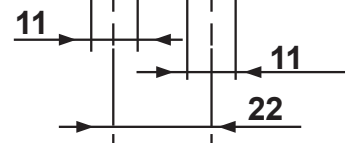
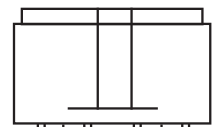

4Pin 2G11

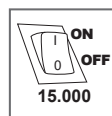
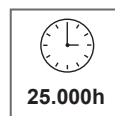

	Codice	Potenza	Lumen Φ360°	Kelvin	Attacco	Fascio (FA)	Dimensioni	Classe Energetica
NEW	39.940416C30	14W	1450lm	3000K	4Pin 2G11	185°	44x20x310mm	F
	39.940416N40	14W	1450lm	4000K	4Pin 2G11	185°	44x20x310mm	F